

Universal metallic anchor for plasterboard, hollow masonries and aerated concrete

Technical data

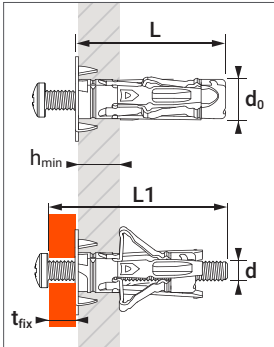

h_{min} (mm)	t_{fix} (mm)
10	20 max.
13	18 max.
>13	15 max.

Anchor size	Screw threaded diameter (mm) d	Base mat. thickness min.-max. (mm) h_{min}	Max. thickness to be fixed (mm) t_{fix}^*	Drilling diameter (mm) d_0	Total screw length (mm) L1	Total anchor length (mm) L	Head type	Code	
								Box ⁽¹⁾	Can
4X35/26	4	10 - 26	15	8	40	35	PZ2	061143	061147 ⁽²⁾
5X35/26	5	10 - 26	15	10	40	35	PZ2	061144	061148 ⁽²⁾
6X35/26	6	10 - 26	15	10	40	35	PZ3	061145	061149 ⁽²⁾
5X35/26 PAV	5	10 - 26	-	10	40	35	PAV M7	-	061146 ⁽³⁾

* for $h_{min} > 13$ mm

⁽¹⁾ Box of 100 anchors / ⁽²⁾ Can of 150 anchors / ⁽³⁾ Can of 300 anchors

Application

- Light duty clamps
- Radiators
- Inside lighting
- Bathroom fixtures
- Kitchen fixtures
- Inside air conditioning units
- Electrical accessories

Setting method

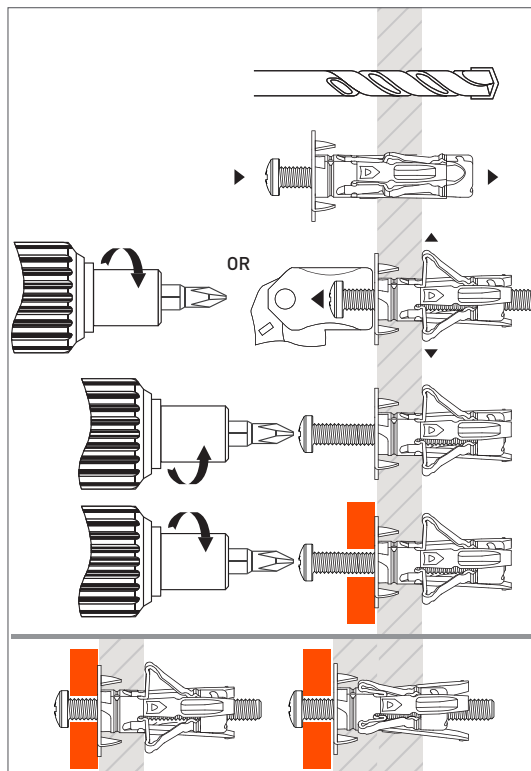

Recommended loads (N_{rec} , V_{rec}) in kN

TENSILE

Base material	Anchor size	Ø4	Ø5	Ø6
Plasterboard BA10/BA13				
N_{rec}		0,15	0,20	0,20
Plasterboard high density HABITO BA13				
N_{rec}		0,40	0,45	0,45
Plasterboard BA25				
N_{rec}		0,20	0,25	0,25
Hollow concrete block B40				
N_{rec}		0,35	0,40	0,40
Hollow clay brick Wienerberger Porotherm				
N_{rec}		0,30	0,35	0,35
Aerated concrete				
N_{rec}		0,15	0,15	0,15
$N_{rec} = N_{Rk} / 3$				

SHEAR

Base material	Anchor size	Ø4	Ø5	Ø6
Plasterboard BA10/BA13				
V_{rec}		0,30	0,45	0,45
Plasterboard high density HABITO BA13				
V_{rec}		0,35	0,50	0,50
Plasterboard BA25				
V_{rec}		0,35	0,50	0,50
Hollow concrete block B40				
V_{rec}		0,30	0,40	0,40
Hollow clay brick Wienerberger Porotherm				
V_{rec}		0,30	0,75	0,75
Aerated concrete				
V_{rec}		0,30	0,40	0,40
$V_{rec} = V_{Rk} / 2,5$				